

ORDINANCE 1209

CITY OF LACEY

AN ORDINANCE OF THE CITY OF LACEY, WASHINGTON, ANNEXING TERRITORY TO THE CITY OF LACEY, ESTABLISHING THE ZONING FOR SUCH PROPERTY TO BE BUSINESS PARK AND APPROVING A SUMMARY FOR PUBLICATION (CREST BUILDERS 20 ACRES)

BE IT ORDAINED BY THE CITY COUNCIL OF THE CITY OF LACEY, WASHINGTON, as follows:

Section 1. A legally sufficient petition for annexation having been filed containing the signatures of the owners of a majority of the acreage for the property shown on Exhibit "A" and legally described on Exhibit "B" attached hereto, and there being no residents of the proposed annexed property, and the said proposed annexation having been duly filed with and processed by the Thurston County Boundary Review Board, and the City Council, after public hearing held pursuant to legal notice, being of the opinion that it is in the best interest of the citizens of the City of Lacey that the annexation petition be granted, the territory described on Exhibit "B" attached hereto and made a part hereof as though fully set forth at length is hereby annexed to the City of Lacey.

Section 2. Pursuant to the terms of the petition for annexation of said property, all property within the territory annexed by Section 1 hereof shall be assessed and taxed on the same basis as property previously within the city for the payment of any bonds issued or debts contracted prior to or existing at

Ordinance No. 1209 page 1 of 2

the date of this annexation.

Section 3. The property in the territory annexed shall be zoned Business Park. All Land Use Regulatory Controls and other controls and development standards for all of the property annexed by this Ordinance shall be in accordance with the ordinances of the City of Lacey.

Section 4. This Ordinance shall take effect five (5) days after its passage and publication as required by law.

Section 5. The summary of this Ordinance, which is attached hereto, is approved for publication.

PASSED BY THE CITY COUNCIL OF THE CITY OF LACEY, WASHINGTON, this 11TH day of SEPTEMBER, 2003.

CITY COUNCIL

BY *Virgil S. Clarkson*
DEPUTY MAYOR

Attest:

Approved as to form:

Carol Litten
DEPUTY City Clerk

[Signature]
City Attorney

Published: SEPTEMBER 15, 2003

Ordinance No. 1209 page 2 of 2

LEGEND

- = LACEY CITY LIMITS
- - -** = PROPERTY ANNEXED BOUNDARY

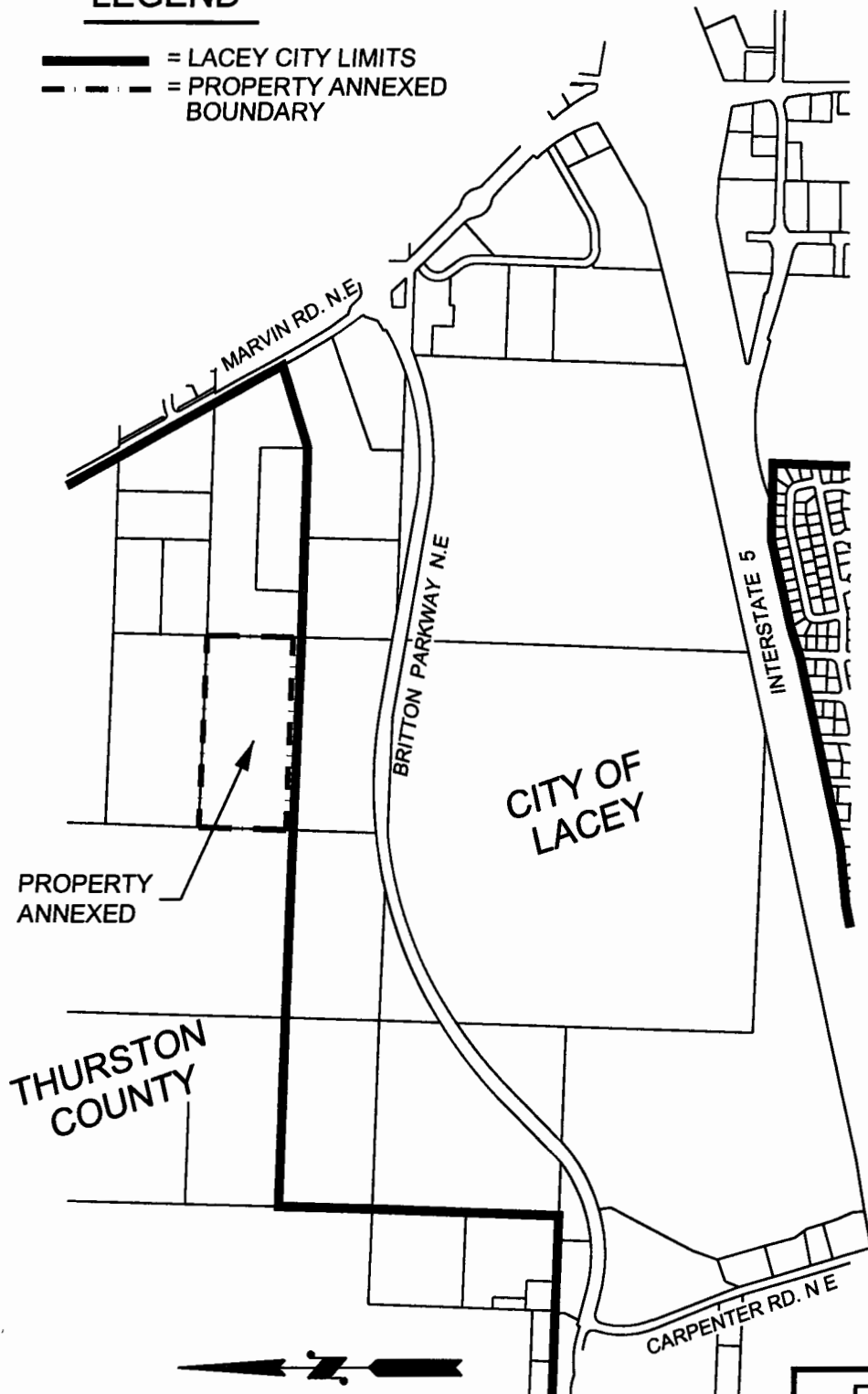

PROPERTY ANNEXED

THURSTON COUNTY

CITY OF LACEY

EXHIBIT A

CITY OF LACEY
ORDINANCE NO 1209

ASSESSOR'S PARCEL NO 11803440000



CITY OF LACEY

ORD \$24 00

3575380
Page. 4 of 6
09/17/2003 08 40A
Thurston Co. Wa

**ANNEXATION DESCRIPTION
CREST BUILDERS INC**

(THURSTON COUNTY PARCEL #11803440000)

The north half, by government measure, of the southeast quarter of the southeast quarter of Section 3, Township 18 North, Range 1 West, W.M., Thurston County, Washington.

Containing 20.14 Acres, more or less.

Prepared at the request of
ENTRANCO

July 8, 2003

Patrick J Beehler, PLS
Certificate No 17656

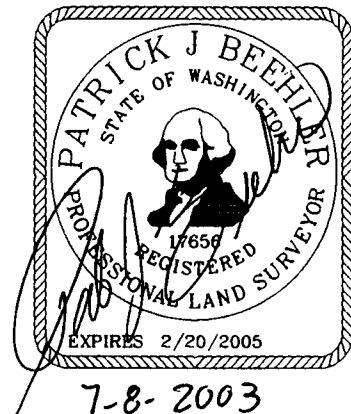

F:\SW SURVEY FILES\Projects\03-1358 ENTRANCO -\1358 ANNEXATION DESCRIPTION doc



3575380

Page: 5 of 6

09/17/2003 08 40A

CITY OF LACEY

ORD

\$24 00

Thurston Co Wa

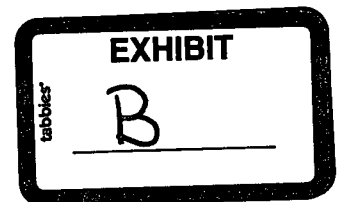

SUMMARY FOR PUBLICATION

ORDINANCE 1209

CITY OF LACEY

The City Council of the City of Lacey, Washington, passed on September 11, 2003, Ordinance No. 1209, entitled "AN ORDINANCE OF THE CITY OF LACEY, WASHINGTON, ANNEXING TERRITORY TO THE CITY OF LACEY, ESTABLISHING THE ZONING FOR SUCH PROPERTY TO BE BUSINESS PARK AND APPROVING A SUMMARY FOR PUBLICATION (CREST BUILDERS 20 ACRES)"

The main points of the Ordinance are described as follows:

The City Council of the City of Lacey approved the annexation of 20 acres of property located north of Britton Parkway and west of Marvin Road into the City of Lacey, said property to be zoned Business Park.

A copy of the full text of this Ordinance will be mailed without charge to any person requesting the same from the City of Lacey.

Published: SEPTEMBER 15, 2003.

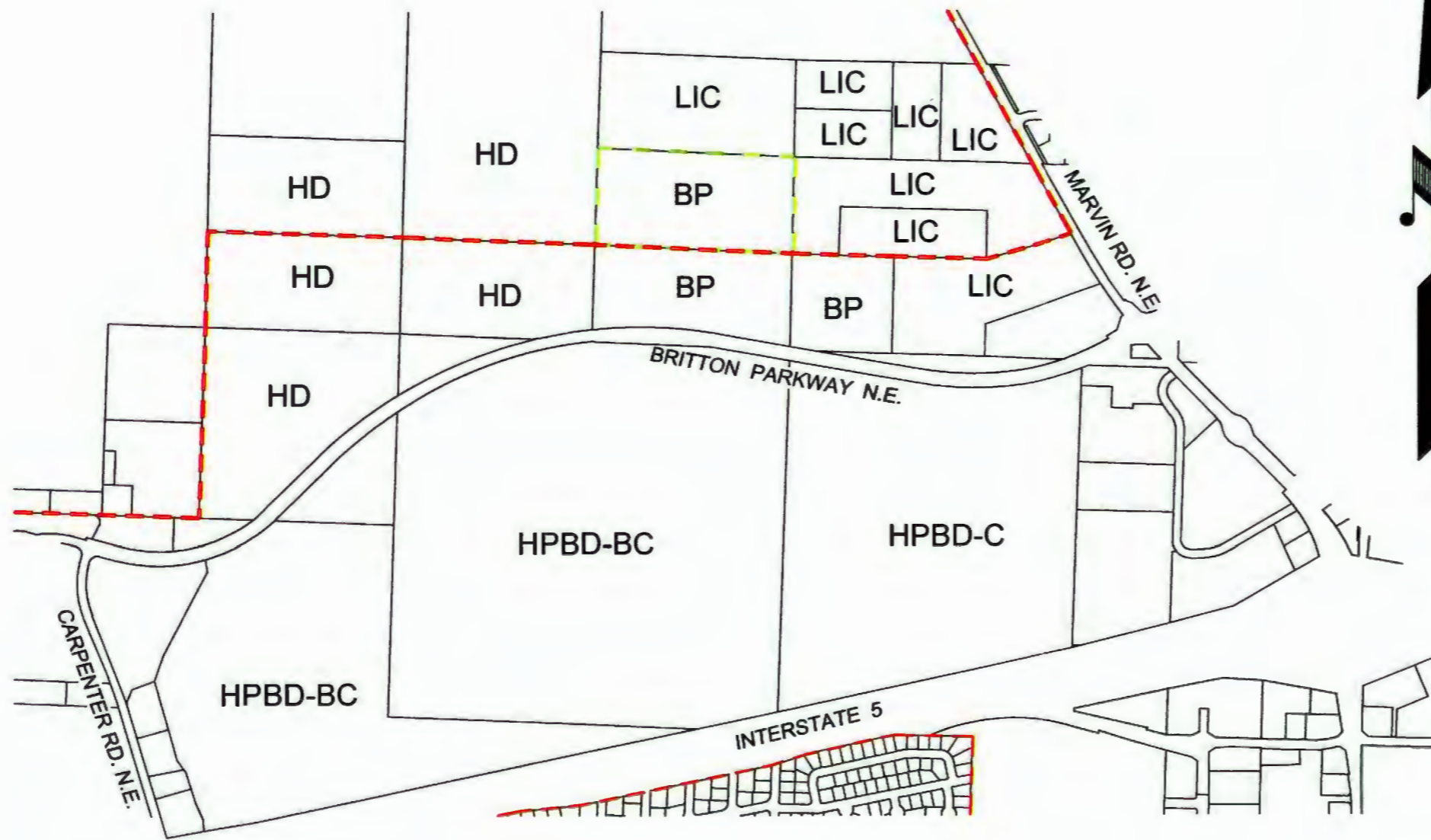

ZONING DESIGNATIONS

- BP = BUSINESS PARK
- HD = HIGH DENSITY RESIDENTIAL
- LIC = LIGHT INDUSTRIAL COMMERCIAL
- HPBD-BC = HAWKS PRAIRIE BUSINESS DISTRICT (BUSINESS COMMERCIAL)
- HPBD-C = HAWKS PRAIRIE BUSINESS PARK (COMMERCIAL)

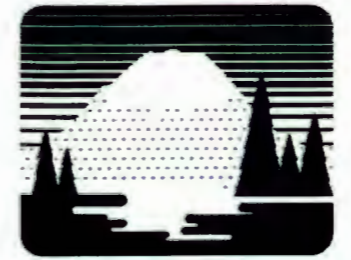

CITY OF LACEY
 Crest Builders
 20.0 ACRE ANNEXATION
 BRB #03-02

**URBAN
 GROWTH
 AREA
 ZONING**

LEGEND

- - - LACEY CITY LIMITS
- - - PROPOSED ANNEXATION

