

City of Lacey
P.O. Drawer B
Lacey WA 98503

8502150068

900

THURSTON COUNTY
OLYMPIA, WASH.

FEB 19 3 12 PM '85

ORDINANCE 715
CITY OF LACEY

REQUESTED BY: Lacey
SAM S RE (AUDITOR)
[Signature] DEPUTY

AN ORDINANCE ANNEXING TERRITORY TO THE CITY OF LACEY AND DECLARING AN EMERGENCY (SOUTH ANNEXATION)

BE IT ORDAINED BY THE CITY COUNCIL OF THE CITY OF LACEY, WASHINGTON, as follows:

Section 1. A legally sufficient petition for annexation having been filed containing the signatures of the owners of more than 75 percent by assessed value of the property described on Exhibit "A" attached hereto, and the said proposed annexation having received the approval of the Thurston County Boundary Review Board, and the City Council, after public hearing held pursuant to legal notice, being of the opinion that it is in the best interests of the citizens of the City of Lacey that this annexation petition be granted, the territory described on Exhibit "A" attached hereto and made a part hereof as though fully set forth at length and all located within Thurston County, Washington, is hereby annexed to the City of Lacey.

Section 2. Pursuant to the terms of the petition for annexation of said property, all property within the territory annexed by Section 1 hereof shall be assessed and taxed on the same basis as property previously within the City for the payment of any bonds issued or debts contracted prior to or existing at the date of this annexation.

8502150068

650210008

Section 3. The property within the territory annexed shall continue to be subject to the primary zoning use designations, density, and design standards specified in Sections 20.18.020 through 20.18.040 of the Thurston County Code until such time as action is taken by the City Council pursuant to public hearing to change the zoning designation of said properties. Lawful uses existing at the date of this annexation shall be allowed to continue and those properties covered by development permits, including building permits, preliminary or final plats of any sort, and site plans for mobile home parks, which have been issued or approved by Thurston County on or before the date of this annexation, shall be permitted to develop in accordance with the terms of said permits. All proposed uses of properties other than those listed as primary uses under Section 20.18.020 of the Thurston County Code, lawful uses existing on the date of this annexation or uses covered by development permits as described herein, shall be processed and approved or disapproved in accordance with Chapter 16.66 of the Lacey Municipal Code relating to special uses. All development standards within the area annexed other than those standards specified in Section 20.18.040 of the Thurston County Code shall be those Lacey development standards prevailing throughout the City.

Section 4. This ordinance is a public emergency ordinance necessary for the protection of public health, public safety, public

8502130068

property or the public peace and shall be effective on its passage by the Council.

PASSED BY THE CITY COUNCIL OF THE CITY OF LACEY,
WASHINGTON, this 14th day of February, 1985.

CITY COUNCIL

By *Bob Brown*
Mayor

Attest:

Timothy McGuire
City Clerk

Approved as to form:

[Signature]
City Attorney

Passed: 2-14-85

Published: 2-20-85

ANNEXATION BOUNDARIES

Section 32, T 18 N, R 1 W, W.M.

That portion of Section 32, Township 18 North, Range 1 West, W.M., lying easterly of the Chehalis Western and Weyerhauser Timber Company Railroad.

Section 33, T 18 N, R 1 W, W. M.

All of Section 33, Township 18 North, Range 1 West, W.M., Excepting therefrom that portion annexed by City of Lacey Ordinance #564 and recorded in Vol. 996, Pg 12, records of Thurston County Auditor.

Section 34, T 18 N, R 1 W, W.M.

The West 35.00 feet of the North 1320 feet, more or less, of the Northwest 1/4 of Section 34, Township 18 North, Range 1 West, W.M..

Section 5, T 17 N, R 1 W, W.M.

The North 30.00 feet of Section 5, Township 17 North, Range 1 West, W.M., lying East of the right of way of the Chehalis Western and Weyerhauser Timber Company Railroad together with an irregular shaped parcel of existing right of way described as follows: Beginning at a point on the East line of said section, said point being 30.00 feet South of it's Northeast corner; thence N 88-35-53 W, parallel with the centerline of Yelm Highway, 110.67 feet; thence S 01-24-07 W, 10.00 feet; thence S 88-35-53 E, 40.00 feet; thence S 43-52-22 E, 43.17 feet; thence S 00-51-09 W, parallel with the east line of said section, 30.00 feet; thence S 89-08-51 E, 40.00 feet to said section line; thence northerly along said section line to the point of beginning.

Section 4, T 17 N, R 1 W, W.M.

4 (P)

The North 30.00 feet of Section 4, Township 17 North, Range 1 West, W.M. lying South and East of Yelm Highway together with two irregular shaped parcels of existing right of way described as follows: PARCEL #1 Beginning at a point on the West line of said section, said point being 30.00 feet, South of it's Northwest corner; thence continuing along said line, S 00-51-09 W, 59.14 feet; thence S 89-08-51 E, 40.00 feet; thence N 00-51-09 W, parallel with said section line, 30.00 feet; thence N 46-12-20 E, 41.47 feet; thence S 88-26-28 E, parallel with the North line of said section, 40.00 feet; thence N 01-33-32 E, 10.00 feet to the South right of way line of the Yelm highway, said point being 30.00 feet, measured at right angles, South of the centerline of said highway; thence Westerly along said line to the point of beginning. PARCEL #2 Beginning at the intersection of the South right of way line of the Yelm Highway extended and the North South centerline of the

MICROFILMED

NE 1/4 of said section; thence Westerly along said right of way line 139.48 feet to the P.C. of a curve; thence Southeasterly around said curve, whose radius point bears S 01-45-20 W, 140.00 feet, thru a central angle of 89-49-20 for an arc distance of 219.48 feet; thence S 88-25-20 E, 60.00 feet to the Easterly right of way line of the Yelm Highway; thence N 01-34-40 E on said line to it's intersection with the South right of way line of said highway; thence West along said south right of way line to the point of beginning.

S-ANNEX 12/12/84

MICROFILMED

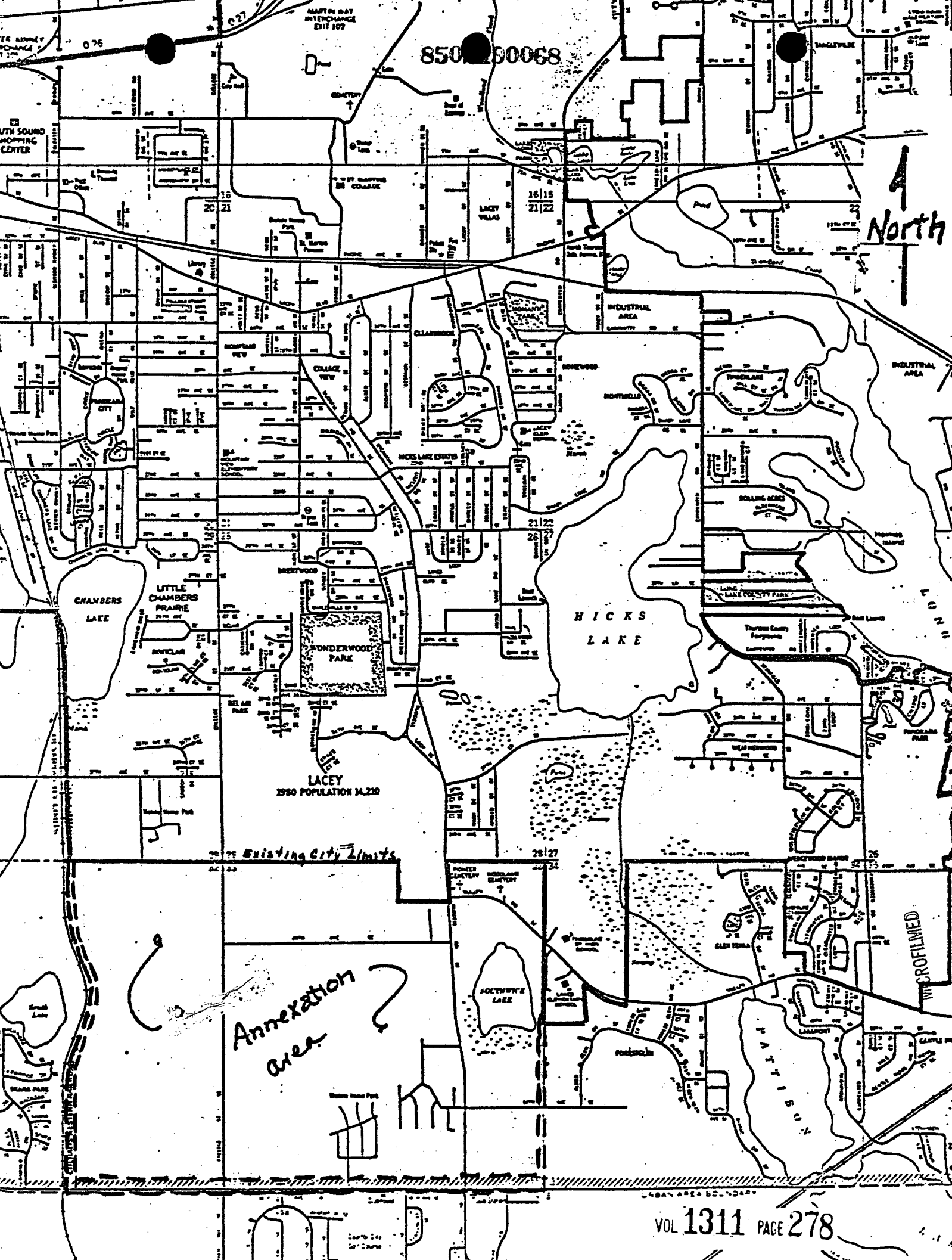

850 290068

North

LACEY
1980 POPULATION 14,210

Existing City Limits

Annexation Area

MICROFILMED

Old city limits line ?

sec. 33 t. 18 n. r. 1 w.

North

New city limits line

LD.

M.D.

MILLER

SOUTHWICK LAKE

SAITH LAKE

8502190058

VOL 1311 PAGE 279

LITTLE PRAME CENTER

MICROFILMED

