

RESOLUTION 661

CITY OF LACEY

A RESOLUTION AMENDING THE LAND USE ELEMENT OF THE LACEY
COMPREHENSIVE PLAN

WHEREAS, the City Council, by passage of Resolution Number 383, adopted the "Lacey Development Plan Land Use and Circulation Elements", which plan has been amended to add new planning elements including that element relating to land used within the southern area of the City adopted by Resolution 597, and

WHEREAS, the Planning Commission of the City of Lacey has considered the matter of proper zoning within the southern portion of the City after referral from the City Council and after public hearing, and has recommended to the City Council that the property shown on Exhibit A, attached hereto, should be redesignated as low density residential, and

WHEREAS, the City Council has duly considered said recommendation and adopted the proposed findings of fact recommended by the Planning Commission and finds that it would be in the best interest of the residents of the City of Lacey that said recommendation be adopted; now, therefore,

BE IT RESOLVED BY THE CITY COUNCIL OF THE CITY OF LACEY, WASHINGTON, that the Land Use Element of that certain document entitled, "LACEY DEVELOPMENT PLAN LAND USE AND CIRCULATION ELEMENTS," as adopted by Resolution Number 383 and amended by

Resolution 597, is further amended to change the land use designation of that property shown on Exhibit A, attached hereto, from medium density residential to low density residential.

PASSED BY THE CITY COUNCIL OF THE CITY OF LACEY, WASHINGTON, this 26th day of April, 1990.

CITY COUNCIL

By Kay M. Boyd
Mayor

Attest:

Karen Maughan
City Clerk

Approved as to form:

[Signature]
City Attorney

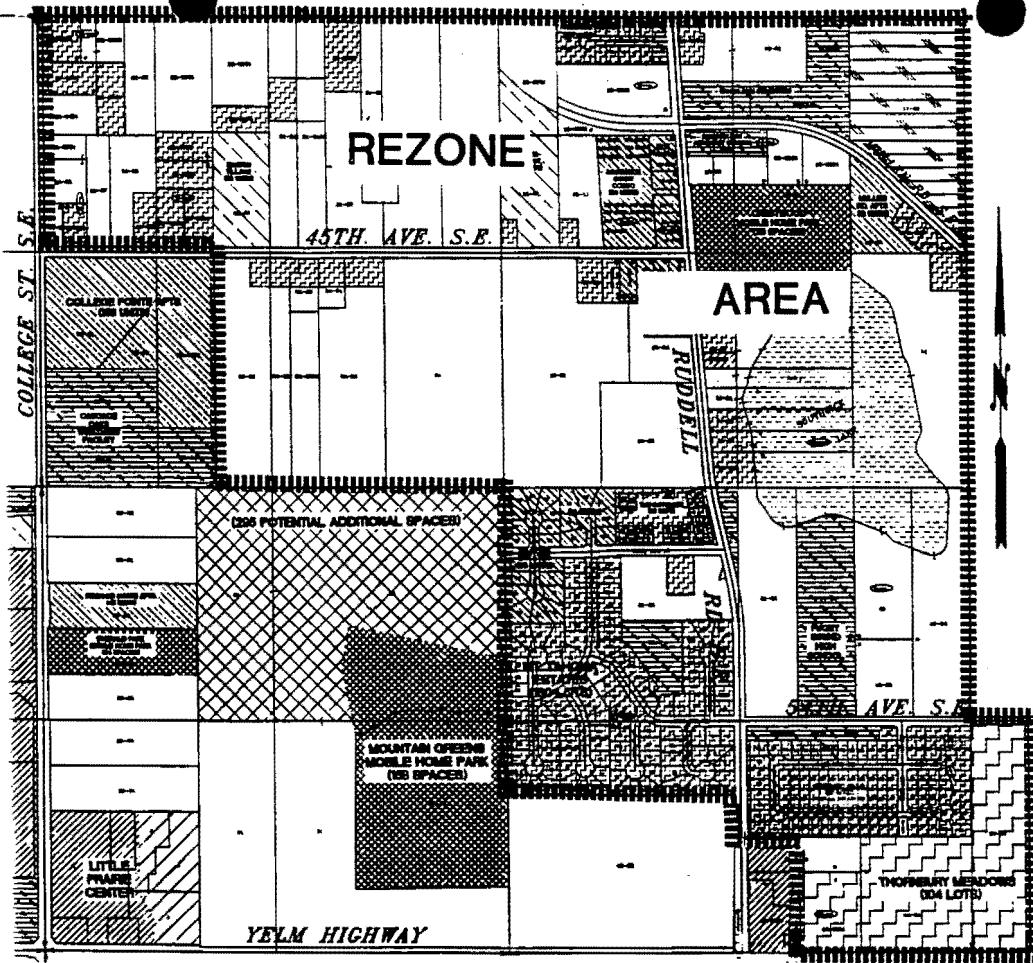

EXHIBIT A

Amendment to Resolution 383 (Lacey Comprehensive Development Plan Map)

Resolution Number 661, 1990.

Redesignation of subject property from Medium Density Residential (MD) designation to Low Density Residential (LD) designation.

Date of adoption: April 26, 1990

Kay M. Boyd
Mayor, City of Lacey

Attest:
Karen Snaught
City Clerk